

Plattenwerkstoff und Oberfläche nach Auftrag
 Definierte Schmalseiten mit Kante belegt.
 Belegte Kante mit min. Radius R2mm versehen

Ausfräsung in der Oberseite / cut out in the top part

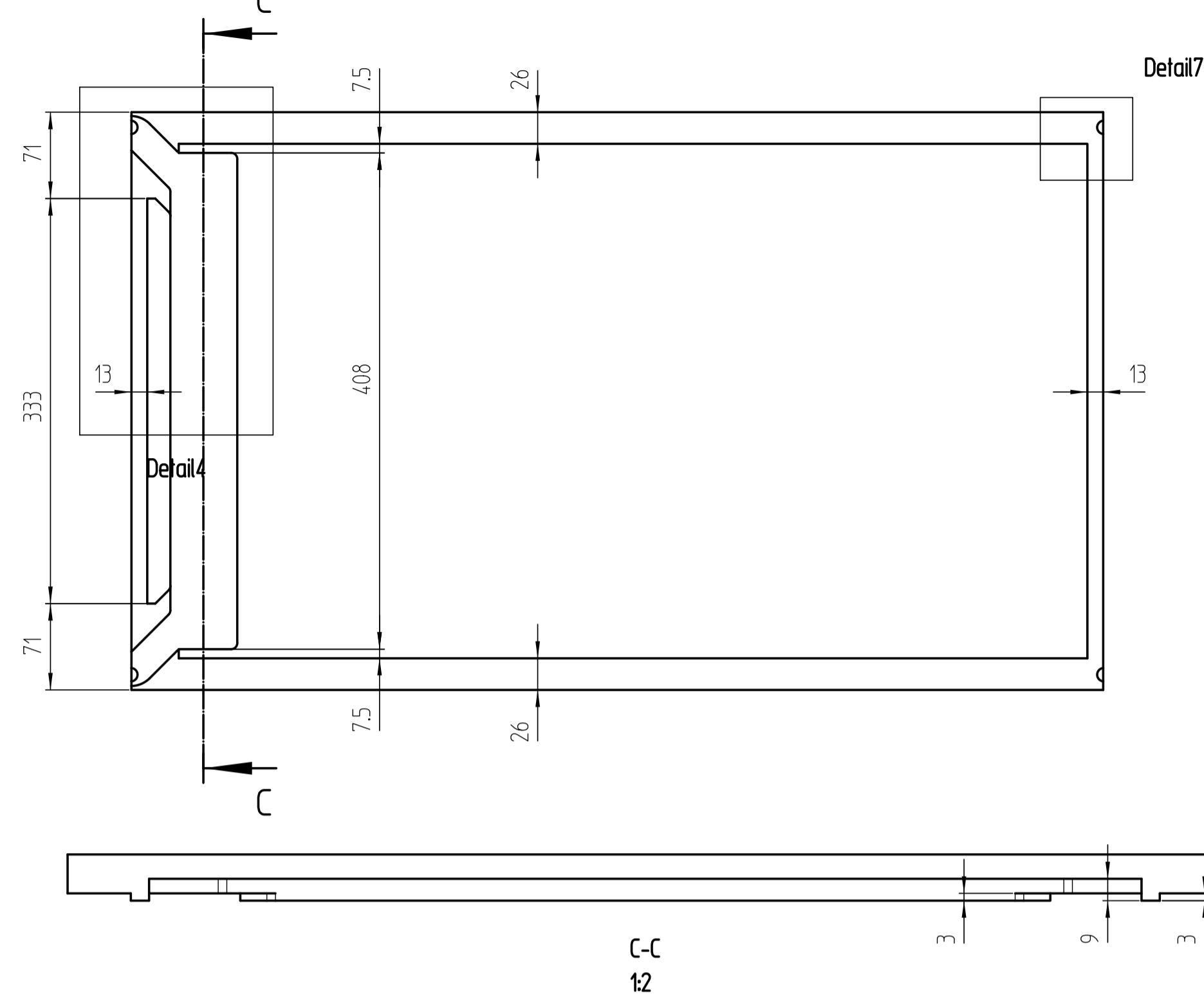

Ausfräsung in der Unterseite / cut out in the bottom part

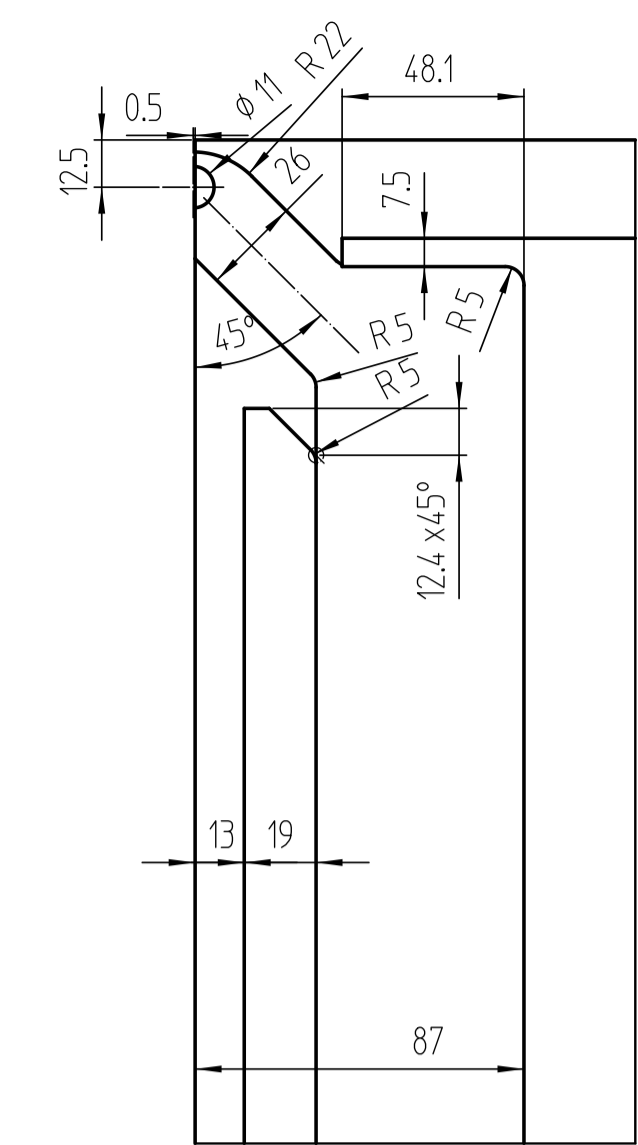
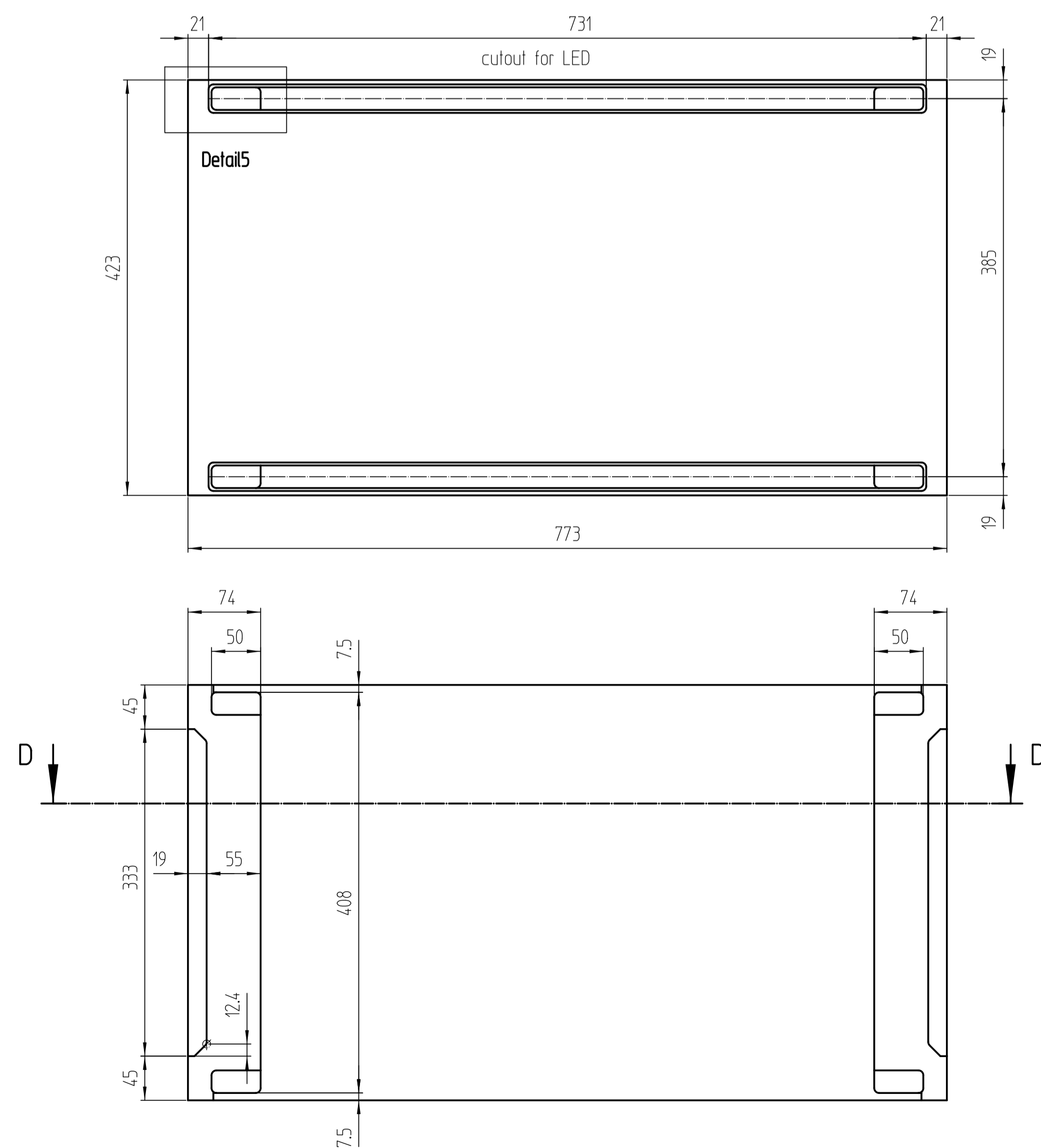

- Zweischaliger Deckel-Aufbau, mit beidseitiger Leuchte / two-part top-construction, with two-sided light.
- Verklebt oder zb. geschraubt im Leuchtenkanal / glued or for example screwed in the light channel.
- Verkabelung und Stecker finden in der Ausfräsung platz / cabling and plugs are in the cut out.
- Deckel kpl. zusammen verleimt / both parts complete glued.
- Elektrifizierung nachträglich möglich / electrification later possible.

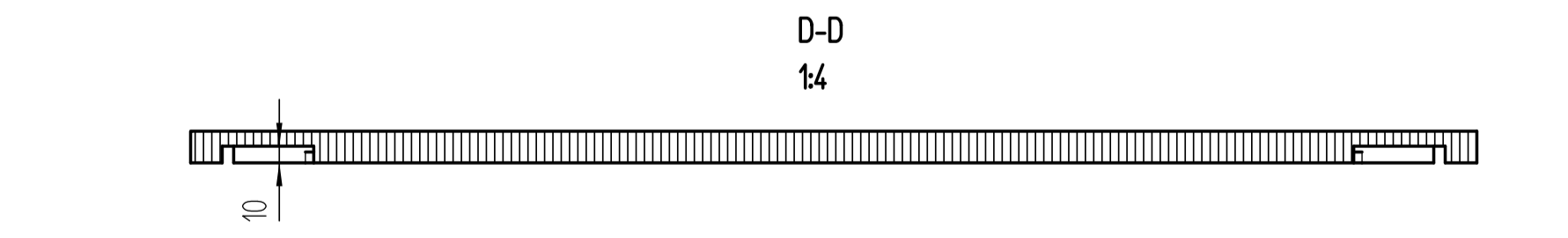
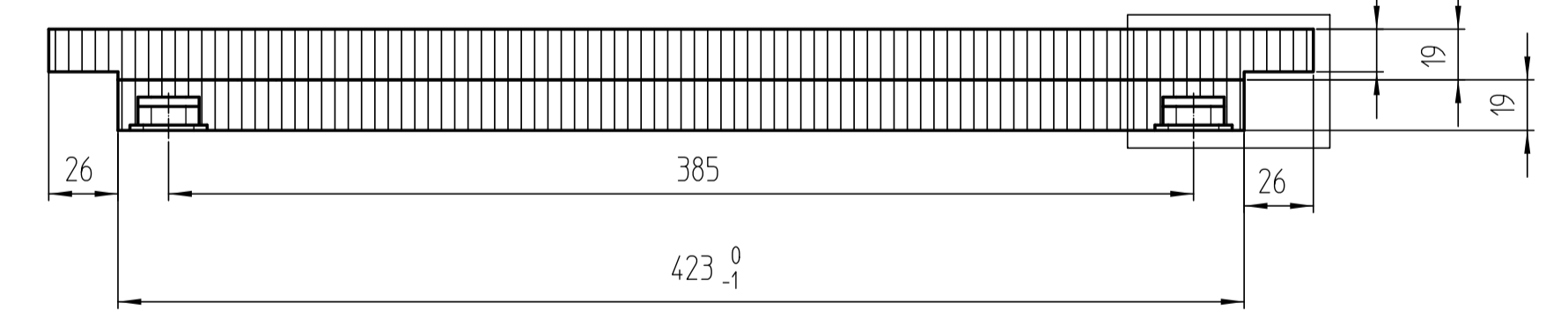
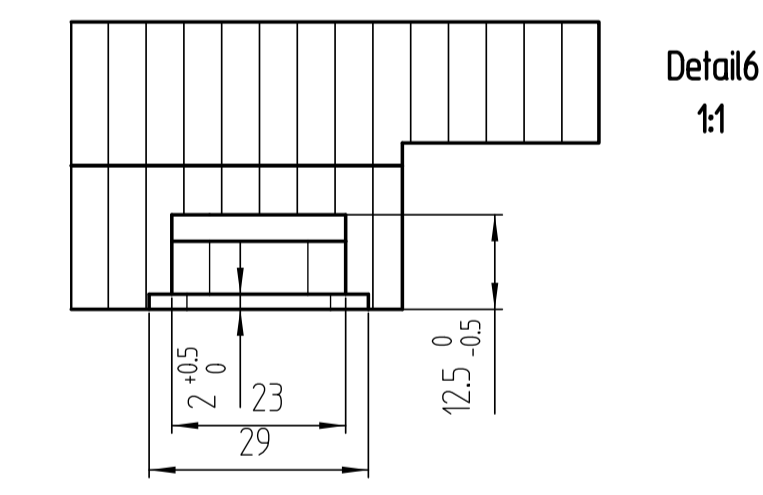
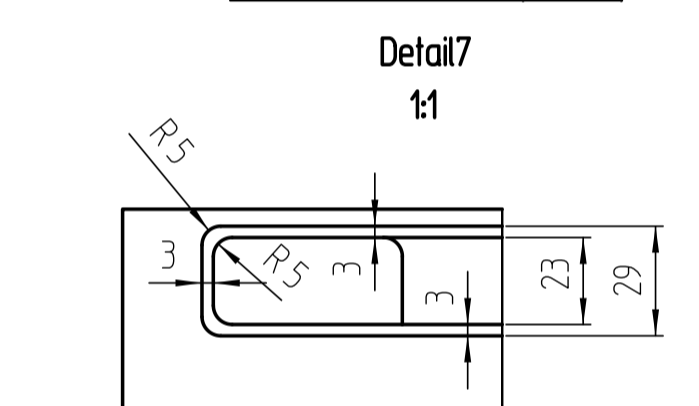
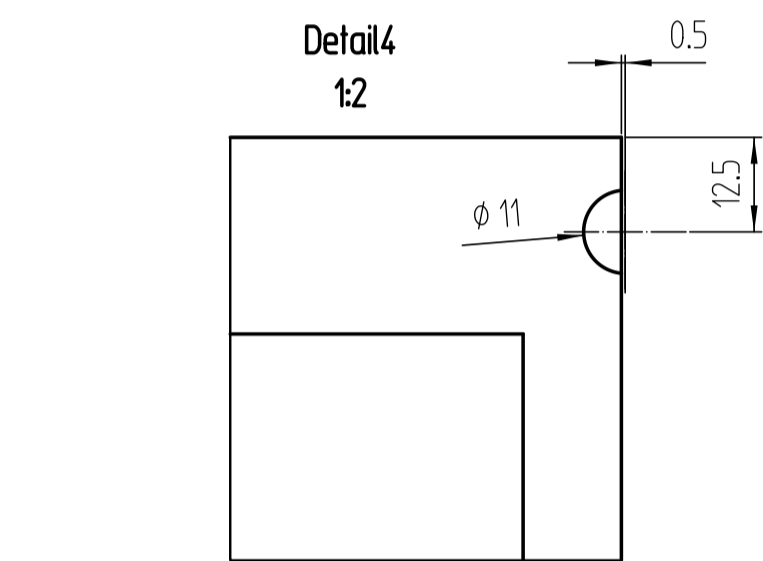
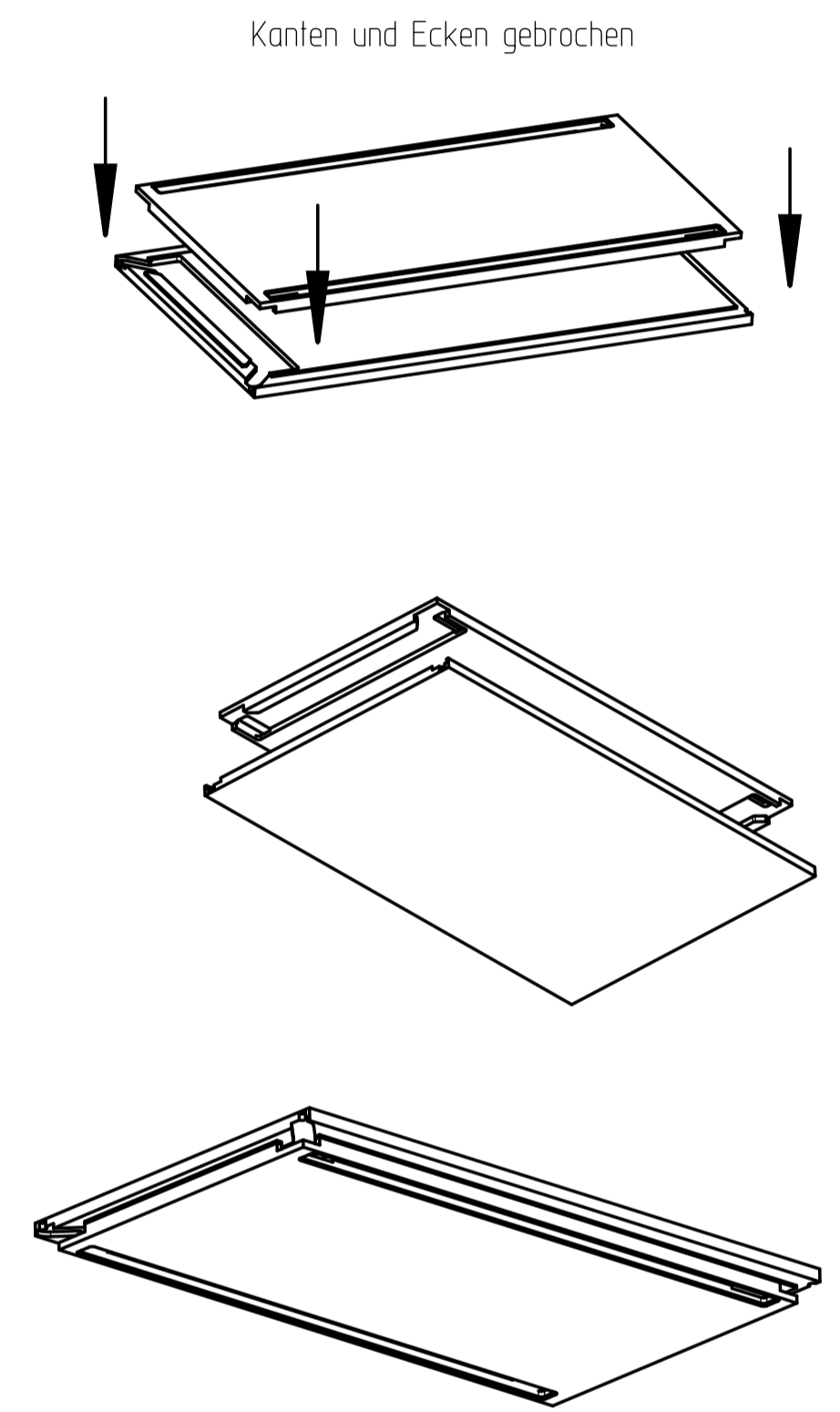

Piece	Designation/Description	Drawing/Mat.-Nr.	Pos	Material	DIN/VBN	Remark
Changes						
Used by		First used for		Foreign designation		Serial index Sheet
Released	Date	Name	Weight/kg	9,102	Development No.	
Designed	10.07.20	Studer_A	Free Dim. Tol.	Main Scale	704-739	1 A 1/1
In Change	31.07.20	Studer_A	HT 25	1:5	Replacement for	
Designation				Abdeckboden mitte T475/A800 Leuchten beidseitig		
Project Customer 901				www.visplay.com		
				visplay		