

Any intellectual property right subsisting in this drawing is owned by our companies. Transmitting, using or copying without permission is prohibited.

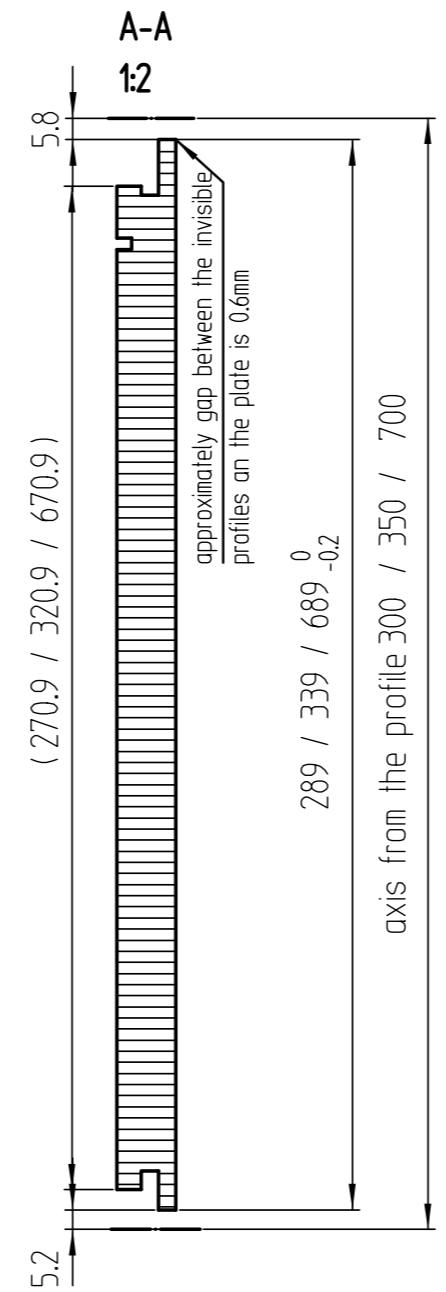

recommended system grating is 350mm,  
suitable substructure on 336-218

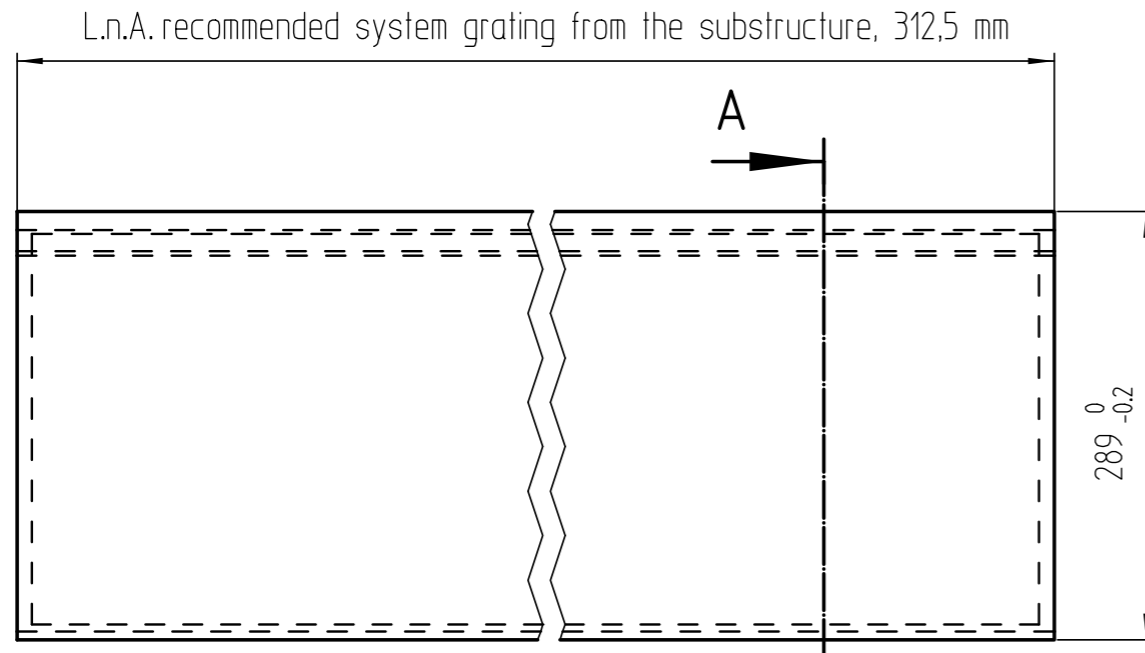
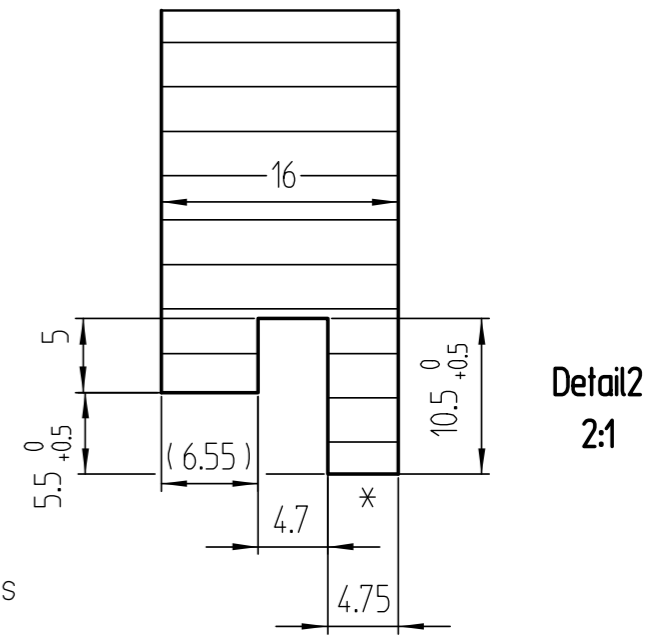
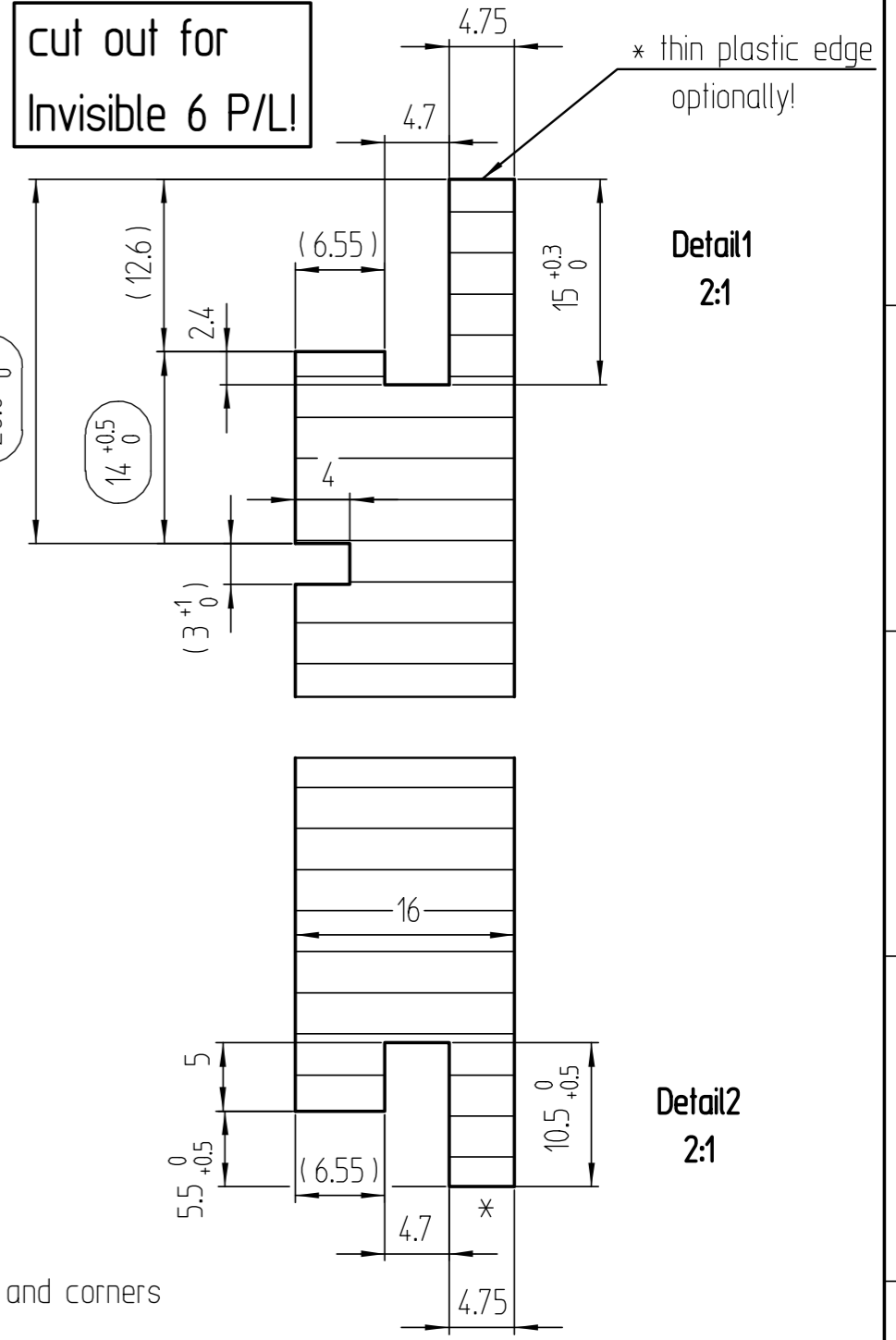

broken edges and corners

board materials with 16mm						
Piece	Designation /Description	Drawing/Mat.-Nr.	Pos	Material	DIN/VBN	Remark
Changings	F Maße ergänzt				Uecker_M	28.11.13
	E Änderung				Uecker_M	25.07.12
Used by		First used for		Foreign Designation		Format Index Sheet
	Date	Name	Wheight/kg	2,278	Development No.	
Designed	23.05.12	Uecker_M	Free Dim. Tol.	Main Scale	365-302 3 F 1	
Released	27.10.14	Uecker_M	ISO 2768-mK	1:5	Replacement for	
In Change						
Designation Invisible cutout for 6 P / L panels						
Projekt Customer992						
www.visplay.com						