

Beam

Assembly and operating instructions

visplay

Assembly dimensions / Layout

❗ Please observe the indications concerning weight loading and ensure that the substructure of the uprights and furniture as well as their fixings can support the expected loads.
With the installation in glass tempered glass must be used.

Assembly dimensions Beam profile

The bore or thread space is 100 mm. Use all fastening points (spaced 100 mm) when screw-fastening the profiles.
The first point is located 30 mm below the upper profile end.
To ensure that the entire back surface of the profiles has contact after assembly, the assembly base must be even and smooth.
Pay attention that all fastening screws are screwed into the aluminium profile thread at least 7 mm.
Use screws with special lengths for assembly to back walls with deviating thicknesses.

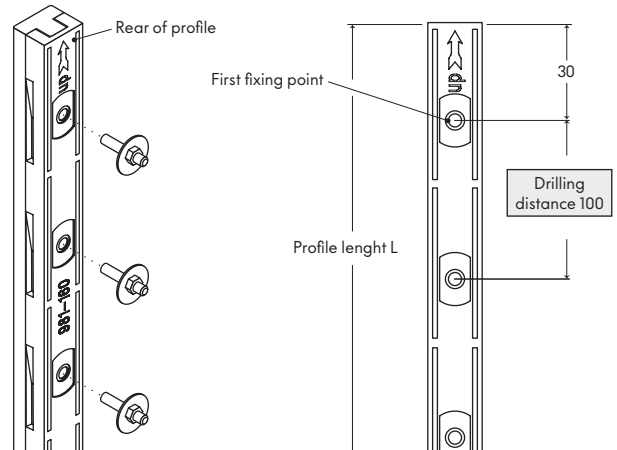

❗ Take care to assemble the profile in the correct direction (upwards). Beam profiles can be cut to size.
Important: Always shorten profiles from the bottom up.

Assembly examples Beam profile

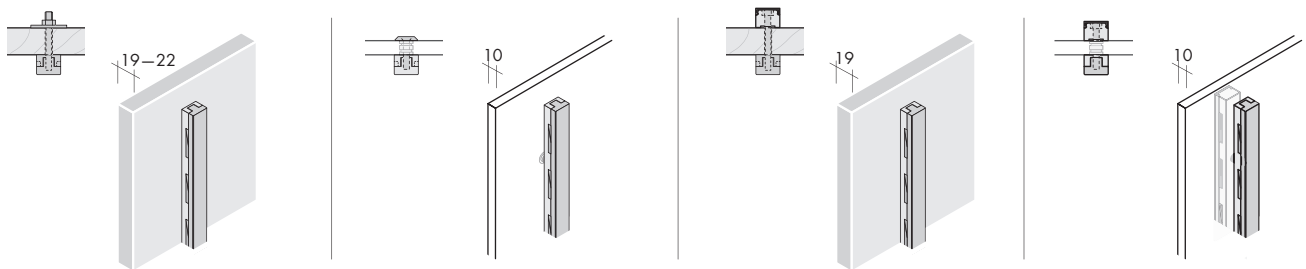

Beam profiles for gondolas

Gondola profiles are available in length of 1200 mm for use in centre-floor furniture.
These have a semi-transparent cover on the upper profile end.

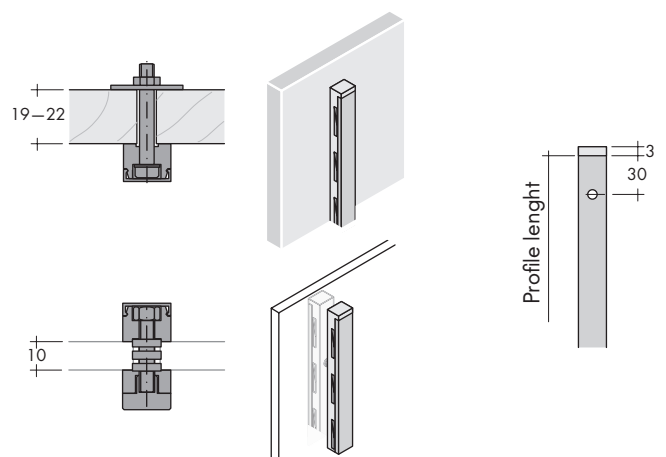

Double-sided assembly

Beam profiles can be fixed to glass **(A)** (10 mm) on both sides with invisible screw connections. The fixing set for glass panels 929-740.05 is to be used (drill holes in glass panel \varnothing 10 mm).

Double-sided screw connections are also possible on wood **(B)**. The screw length depends on the thickness of the wood and must be determined by the customer (e.g. panel 16 mm to 19 mm -> M5x35, DIN7984).

Beam 67 is supplied with standard screws for 19 mm wood, or 10 mm glass.
Please be ensured that the fixation bolts with min. 9 mm are screwed into the profile.

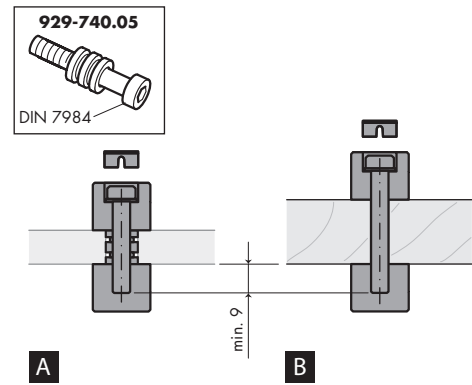

Beam profiles for rear assembly on glass or wooden panels

- on glass panel **(A)**:

Beam profiles are fixed on to glass panels (10 mm) with countersunk screws (1), washers (2) and plastic sleeves (3). Drill holes of \varnothing 10 mm are to be provided for in the panel.

- on wooden panels **(B)**:

Beam profiles are fixed on to the panel (19–22 mm) with set screws (1), nuts (2) (M5) and washers (3).

Drill holes of \varnothing 6 mm are to be provided for in the panel.

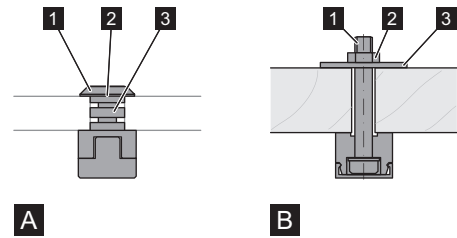

Front attachment to cavity walls

For front attachment to cavity walls, the fixing set 929-178.21 is to be used.

- Drill \varnothing 12 mm hole.
- Insert cavity dowel (fixing set 929-178.21) using pliers (Recommendation: Cavity pliers HM z1 from Fischer®) and expand.
- Unscrew the pre-assembled screw.
- Add Beam profile and secure with aforementioned screw.
- Assembly has been correctly completed when the screw has been tightened up as far as possible (2 Nm).

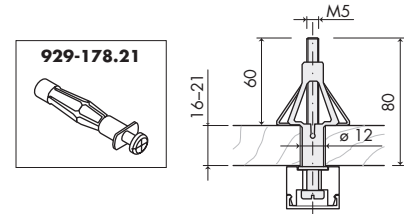

! When using the fixing set (929-178.21), the max. permissible weight per front arm is reduced to 15 kg.

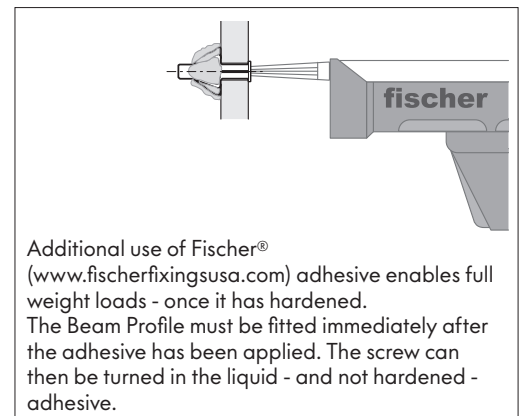
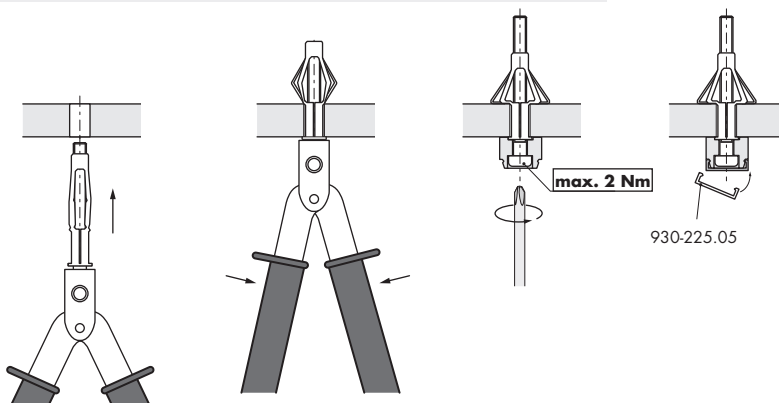

Fastening examples

Depending on the type of wall the profil can be attached with different fixation material.

The max. weight load of the profile depends on the nature of the wall, on the number of fixation points as well as on the fixation material used.

With wooden substructures, a screw length of min. 50 mm must be observed.

- ❗ Please observe the information on the loading values and ensure that the substructure of the wall installation and its fastenings can cope with the expected loads.
 - > The correct size and type of anchor fixings must be used to suit the construction conditions.
 - > Check anchor fixing as specified by manufacturer.
 - > All mounting points must be used.

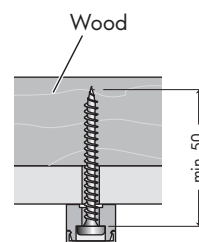

Assembly dimensions Beam profile for attachment from the front

The bore or thread space is 500 mm. Use all fastening points (spaced 500 mm) when screw-fastening the profiles.

The first point is located 155 mm above the lower profile end.

Use screws with special lengths for assembly to back walls with varying thicknesses; recommended: panhead screws with head diameter max. 12 mm.

Pay attention that the enclosed screws (5 pcs.) are screwed into the aluminium profile after wall mounting.

- ❗ Take care to assemble the profile in the correct direction (upwards). Beam profiles can be cut to size. Important: Always shorten profiles from the bottom up.

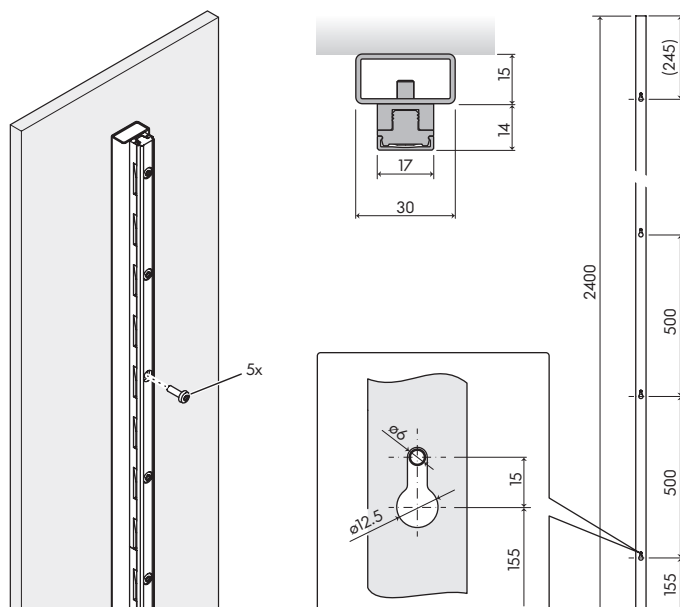

Assembly instructions for the Beam profile for attachment from the front

1. Drill 5 holes at **500 mm** intervals. Tighten mounting screws and leave them protruding by approx. **5 mm** (note: to select the right fixtures, see below "Front assembly on different surfaces").
2. Hook the Beam profile over the screws. Tighten the screws through the holes in the profile. The diameter of the tool must not exceed **4 mm**.
3. Screw the supplied screws (5 pcs.) into the profile.
4. Fit the profile cover.

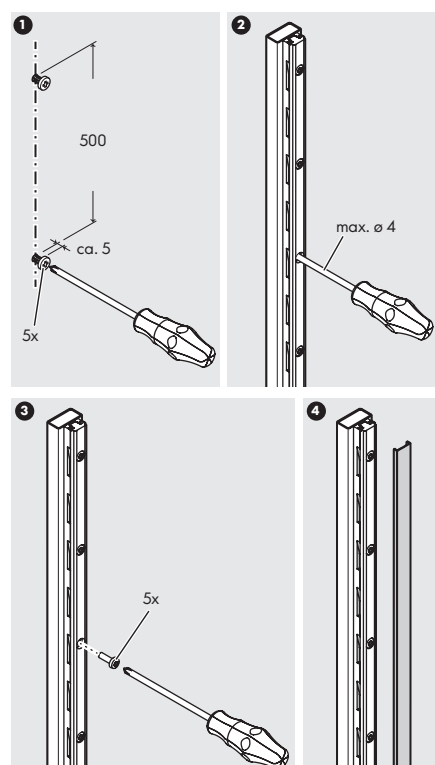

Fastening examples

Depending on the type of wall the profil can be attached with different fixation material.

The max. weight load of the Invisible 6 P/L profile depends on the nature of the wall, on the number of fixation points as well as on the fixation material used.

With wooden substructures, a screw length of min. 50 mm must be observed.

For mounting on plaster, the following dowels are recommended (manufacturer Hilti):

- Hollow toggle plug HTB-S M5x60
- Hollow plug HHD-S M5/12x52

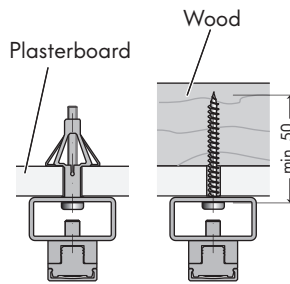

- ⓘ Please observe the information on the loading values and ensure that the substructure of the wall installation and its fastenings can cope with the expected loads.
- > The correct size and type of anchor fixings must be used to suit the construction conditions.
 - > Check anchor fixing as specified by manufacturer.
 - > All mounting points must be used.

Assembly of cover profile

Insert one side of the cover profile into the groove of the Beam profile and snap the other side into place through pressure or with light blows from a large rubber hammer.

Apply blows evenly along the cover profile as otherwise it could be damaged.



- ⓘ The cover profile is to be secured in place with adhesive (silicone).
Attention: Once a cover profile has been assembled, it cannot be removed without being damaged.

Instructions of use/Care

Beam accessories can be vertically adjusted at a pitch of 50 mm.

- ⓘ Please observe that the accessories must be relieved of any load when adjusting the height.
It is thus recommended that the accessories are moved with two hands.

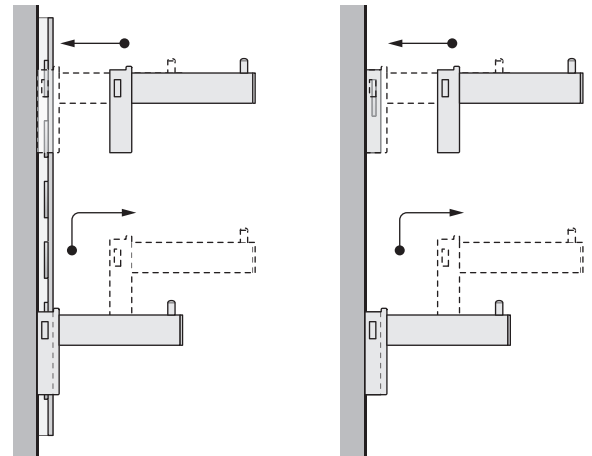

Single-sided and double-sided Beam profiles can be screwed on wooden panels (19–22 mm), glass panels (10 mm) or plexiglass panels.

Panels and sub-structures must be toughened against bowing. Wooden ledges or angle sections are suitable for this purpose.

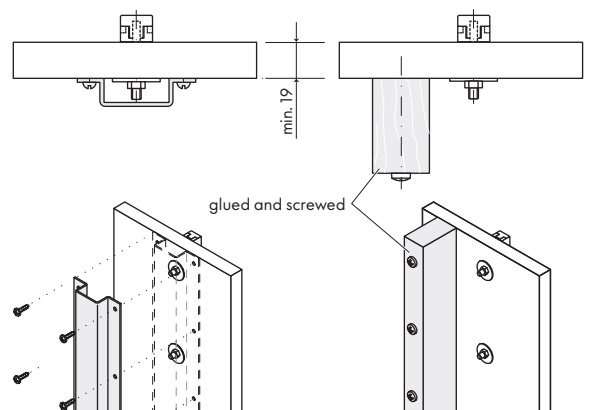

Fixing set for Beam profiles

To be screwed to the back of wooden panels.

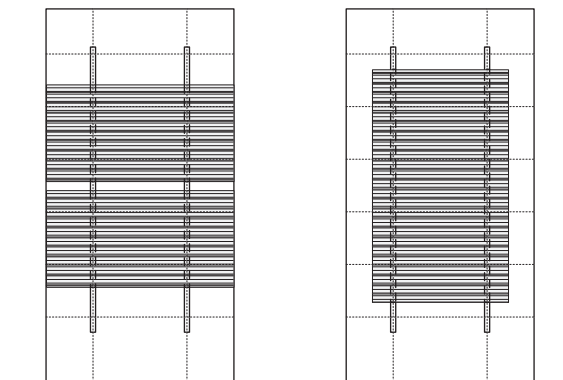
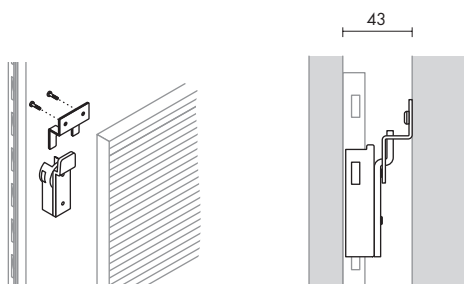

Weight loading

- ❗ The max. weight loading depends on the nature of the wall, on the number of fixation points as well as on the fixation material used. At least 10 fixation points are necessary per metre of Beam profile.
- The indicated weight loads for the Beam accessories are always based on the total weights of the merchandise support and goods.
- Please observe that the inclination of the merchandise support changes with an increase in load. Different weights on the merchandise supports produce an uneven overall appearance of the goods display.
- Please also observe the weight loads indicated in our sales documentation.

Max. load

Profile	per 1000 mm	75 kg
Front arm Ø 12 mm		10 kg
Front arm Ø 25 mm		20 kg
Support bracket Ø 25 mm for wooden or glass shelf		20 kg
Support bracket 25 x 4 mm for wooden or glass shelf		20 kg
Hanging rail Ø 15 mm, 390 mm T arm		10 kg
Hanging rail Ø 25 mm, 600 mm T arm		20 kg
Hat bar		3 kg
Bracket for hanging rail 30 x 15 mm, oval	per bracket	20 kg
Bracket Ø 12 mm for hanging rail Ø 15 mm	per bracket	10 kg
Bracket Ø 12 mm for wooden or glass shelf	per bracket	10 kg
Bracket Ø 25 mm for wooden or glass shelf	per bracket	20 kg
Bracket Ø 25 mm for hanging rail Ø 25 mm	per bracket	20 kg
Bracket Ø 25 mm for hanging rail Ø 25 mm and shelf	per bracket	20 kg
Fixing set		20 kg

visplay

www.visplay.com

info@visplay.com